

---

# GGN - Geopark Annual Report 2022

## 1. GEOPARK IDENTITY

2. Name, nation and area network of the Geopark: Wudalianchi UNESCO Global Geopark (China, APGN )

Year of accession/ year of re-evaluation:2004/2008/2012/2014/2018/2022

### Representative Photos

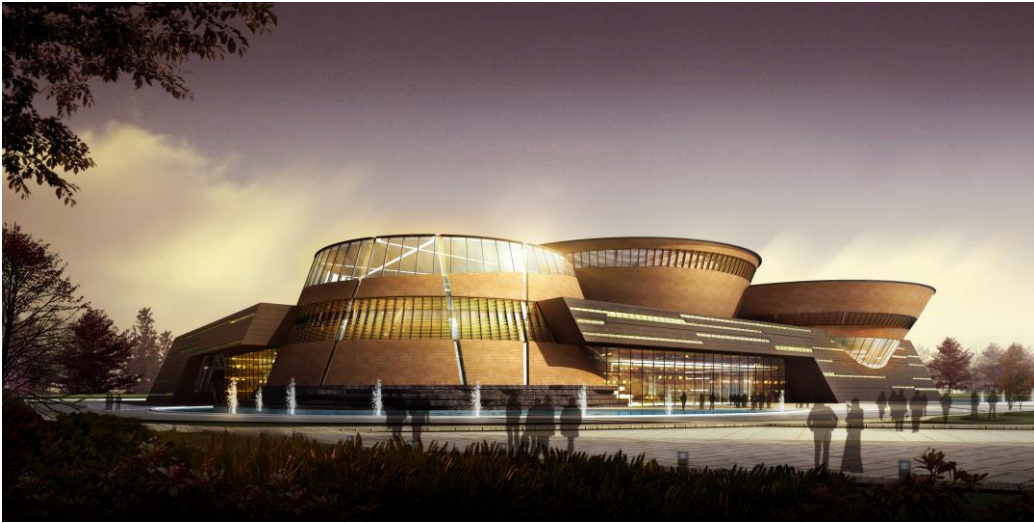

Wudalianchi Global Geopark Museum has completed the exhibition and officially opened to tourists.

## 2.GEOPARK FIGURES

**Number of staff in the Geopark:** 1,801

**Number of tourists:** totally 549,000 person time

**Number of activities:** 16

**Number of Geopark educational projects in school:** 16

**Number of publications issued by geopark:** 1

*The Development Report of Geoparks in China.*

## 3. GEOPARK ACTIVITIES

### Main achievements in 2022

- Organized annually many activities, such as Wudalianchi Volcano Holy Water Festival, Volcano International Marathon Race and New Year Climbing, etc.;
- Cooperated with universities at home and abroad, in which students join researching studies held in the Geopark.

- 
- Discount tickets policies for pupils has been formulated and published by the Geopark, which encourage pupils, middle school students and college students to visit the park.
  - Provided free publicity materials for teaching institutions such as poster foldout, Wudalianchi Scientific Expedition Guide and Wudalianchi Touring Guide, etc.
  - Published promotion information such as pupil discount tickets through CCTV, Heihe TV, Wudalianchi Global Geopark TV and domestic magazines.
  - Released preferential policies and related news of Geopark by the website of the park and cooperated organizations. Sent information through Wechat and Weibo, release preferential policies, encourage tourists to visit the Wudalianchi.

#### **Contribution to GGN - Network activities and Participation**

- Took part in the online Geotourism Symposium in April 2022.
- During the third week of APGN 2022, the park cooperated with Yandangshan, Danxiashan, Lushan, Mt. Tai, Zhangjiajie and other 21 geoparks.
- Took part in the Welcoming New Geoparks Members in May 2022;
- Took part in the Beijing Normal University Natural Education Meeting and made a report in May.
- Took part in China Popularization Forum and made a report in May 2022;
- Yimengshan Global Geopark visited Wudalianchi and signed sister geopark contract in August 2022;
- Took part in celebrating International Geodiversity Day meeting in Sep 2022;
- Took part in APGN Conference in Sep 2022;
- Held the Fourth China Volcano Geopark Forum in No. 2022 .
- Signed sister geopark contract with Imbabura Global Geopark in Ecuador

#### **Management and financial status**

- Management body: Wudalianchi UNESCO Global Geopark Administration Committee
- Financial status: The Geopark achieved a good balance of payments and financial stability. In 2022, the Geopark received tourists 549,000 person times and tourism revenue reached 0.1647 billion Chinese Yuan.

#### **Geoconservation**

- Formulated the Prevention and Control Plan for Geological Disasters in flood Season of 2022 and the Emergency Plan for Sudden Geological Disasters of 2022

---

for Wudalianchi National Park; According to the work requirements of the plan, the investigation and monitoring of the general rock and snow cave prevention and control points in Laohei Volcano Scenic Area are carried out regularly.

- A total of 4.8 million yuan has been allocated from the central finance for the Forestry Grassland Wudalianchi National Nature Reserve project, and the government has completed the bidding for the purchase of protection facilities and equipment.

#### **New educational plans for geoheritage conservation, sustainable development and disaster risk reduction**

The Geopark cooperated with Wudalianchi senior middle school, Wudalianchi junior middle school, Wudalianchi No. 1<sup>st</sup> primary school and No., 2<sup>nd</sup> primary school on giving “Science Knowledge Courses” and completing science popularization textbook “Close to Nature-Approaching Wudalianchi”. There are 10 parts in the textbook and 1033 students joint the 16 class hours.

#### **Strategic partners**

- Cooperated with Wudalianchi Volcano and Earthquake Monitoring Station on the study of Wudalianchi Volcanic Cluster deep structure and activity.
- Cooperated with Northwest University on *Know the Nature of Earth's Mantle from the Perspective of Lava in Earth Land*
- Collaborated with University of Science and Technology of China, China University of Geosciences (Beijing), Jilin University, Heilongjiang Institute of Technology, Heilongjiang University, Northeast Forestry University and Heilongjiang Hydrogeology and Engineering Geology Survey Bureau carried out scientific research.

#### **Promotion activities**

The Geopark has promoted Wudalianchi ads. on CCTV radio, Heilongjiang TV station, mainstream media, newspapers and periodicals all the year round.

#### **4. Contacts:**

Manager: Gong Kai, Email: wdlcgpp@163.com

Geologists: Liu Jiaqi, Academician, Chinese Academy of Sciences;

Huang Rongfu, President, Heilongjiang Ecological and Geological Survey.